

**CARATTERISTICHE COSTRUTTIVE / CONSTRUCTION FEATURES
CARACTERÍSTICAS CONSTRUCTIVAS / CARACTÉRISTIQUES D'EXÉCUTION**

Corpo pompa	acciaio AISI 304
Pump body	stainless steel AISI 304
Cuerpo bomba	acero AISI 304
Corps de pompe	acier AISI 304
Supporto motore	alluminio
Motor bracket	aluminium
Soporte motor	aluminio
Support moteur	aluminium
Girante	Noryl® o acciaio AISI 304, Noryl® (INOXR)
Impeller	Noryl® or stainless steel AISI 304, Noryl® (INOXR)
Rodete	Noryl® o acero AISI 304, Noryl® (INOXR)
Turbine	Noryl® ou acier AISI 304, Noryl® (INOXR)
Tenuta meccanica	ceramica-grafite
Mechanical seal	ceramic-graphite
Sello mecánico	cerámica-grafito
Garniture mécanique	céramique-graphite
Albero motore	acciaio AISI 416
Motor shaft	stainless steel AISI 416
Eje motor	acero AISI 416
Arbre moteur	acier AISI 416
Temperatura del liquido	
Liquid temperature	0 - 50 °C
Temperatura del líquido	
Température du liquide	
Pressione di esercizio	
Operating pressure	max 6 bar
Presión de trabajo	
Pression de fonctionnement	
MOTORE / MOTOR / MOTOR / MOTEUR	
Motore 2 poli a induzione	3~ 230/400V-50Hz
2 pole induction motor	1~ 230V-50Hz
Motor de 2 polos a inducción	con termoprotettore with thermal protection
Moteur à induction à 2 pôles	con protezione térmica avec protection thermique
Classe di isolamento	
Insulation class	F
Clase de aislamiento	
Classe d'isolation	
Grado di protezione	
Protection degree	IP44
Grado de protección	
Protection	



TYPE	TRUCK		CONTAINER	
	PALLET (cm)	N° pumps	PALLET (cm)	N° pumps
INOX	80X120X145	77	80x120x190	88



Pompa auto-adescente di tipo centrifugo adatta per approvvigionamento d'acqua (anche se miscelata a gas) in piccoli impianti domestici, accoppiate a serbatoi autoclave per il trasferimento di liquidi e svuotamento di serbatoi; utilizzate in applicazioni industriali di media entità e per il giardinaggio.

Self-priming centrifugal pump for water supplies (even if mixed with gas) in small household systems, connected to autoclave tanks for transferring liquids and emptying tanks; used in medium sized industrial applications and for gardening.

Bomba auto-aspirante de tipo centrifugo para el suministro de agua (aunque esté mezclada con gas) en pequeñas instalaciones domésticas, acopladas en equipos de presión para la transferencia de líquidos y el vaciado tanques; utilizadas en aplicaciones industriales de media importancia y para la jardinería.

Pompe auto-amorçante de type centrifuge, apte à l'approvisionnement d'eau (même si mélangée à des gaz) dans les petites installations domestiques, l'accouplement à des réservoirs, le transfert de liquides et le vidage de réservoirs; peut être utilisée dans des applications industrielles de moyenne entité et pour le jardinage.

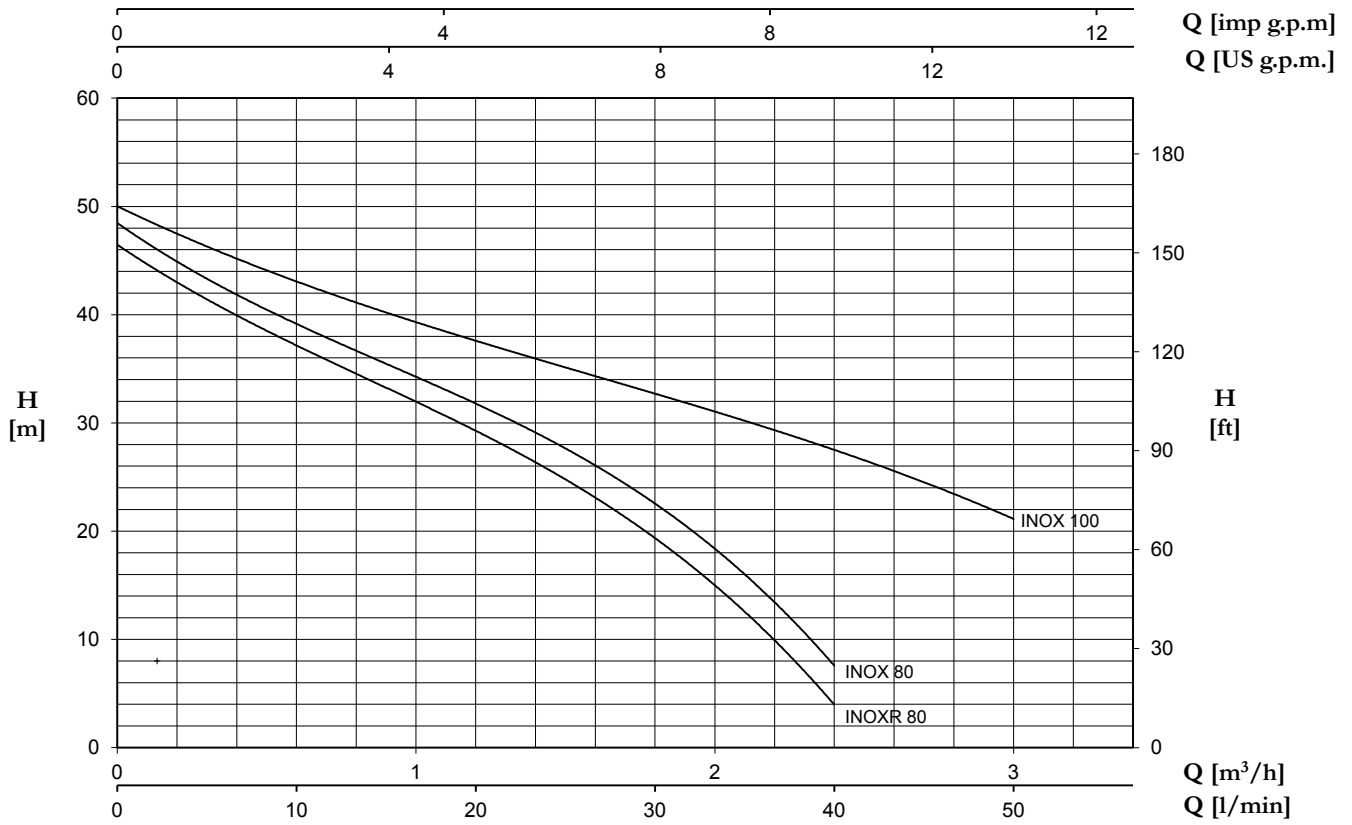

TYPE		P2		P1 (kW)		AMPERE		Q (m³/h - l/min)					
1~	3~	(HP)	(kW)	1~	3~	1~	3~	0	0,6	1,2	1,8	2,4	3
								0	10	20	30	40	50
						1x230 V 50 Hz	3x400 V 50 Hz	H (m)					
INOXR 80	INOXRT 80	0,8	0,59	0,78	0,79	3,6	1,4	46,5	37	29,5	19,2	4	-
INOX 80	INOXT 80	0,8	0,59	0,79	0,79	3,7	1,4	48,5	39	32	22,4	7,6	-
INOX 100	INOXT 100	1	0,74	0,98	1	4,6	2,2	50	43	38	32	28	21

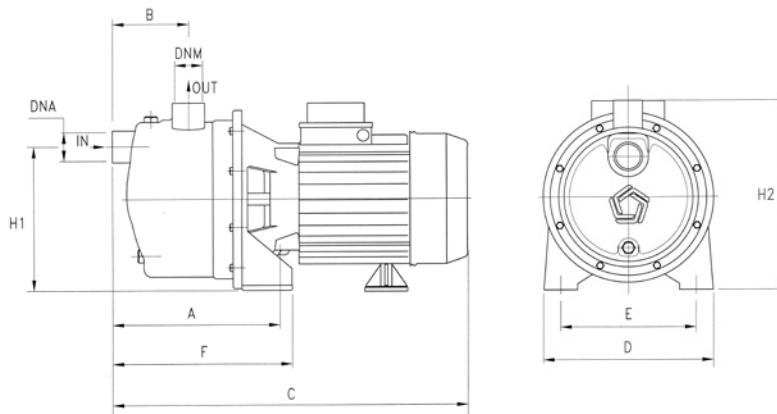

TYPE	DIMENSIONS (mm)													Kg
	A	B	C	D	E	F	H1	H2	DNA	DNM	I	L	M	
INOXR 80	165	79	352	175	140	175	150	199	1" G	1" G	400	210	235	7.9
INOX 80	165	79	360	175	140	175	150	199	1" G	1" G	400	210	235	8.7
INOX 100	165	79	360	175	140	175	150	199	1" G	1" G	400	210	235	9.9

JETINOX

STAINLESS STEEL SELF-PRIMING PUMPS

Self-priming, high intake capacity

The self-priming pumps in the JETINOX range combine the advantages and practical features of centrifugal pumps with the functionality of self-priming pumps, as well as quality performance. The Venturi pipe system on these pumps guarantees optimal hydraulic performance and impressive suction capacity, maintaining priming even in the presence of air or gas bubbles trapped in the water.

MOTOR

- Closed, ventilated from exterior.
- Protection rating IP 44.
- Insulation class F.
- Single phase power supply with permanently activated capacitor.
- Thermal cutout protection incorporated in motor winding.
- Rotation speed 2850 rpm.
- Continuous duty.

APPLICATIONS

- Lifting and distribution of water in domestic systems, with continuous or intermittent duty.
- Pressure booster systems.
- Washing, irrigation of vegetable gardens, supply to fountains, transfers.
- Lifting from wells or cisterns.

USAGE DATA

- Type of liquid: clean water without suspended solid bodies or abrasive material.
- Maximum liquid temperature: 50°C.
- Maximum recommended suction height: 8 m with foot valve.
- Maximum operating pressure: 6 bar.



TABLE OF MATERIALS

Component		Material
1	Pump body	Stainless steel X5 CrNi 1810 (AISI 304)
2	Motor casing	Die-cast aluminium
3	Impeller	Technopolymer with stainless steel shim ring
4	Diffuser monobloc group Venturi tube-nozzle	Technopolymer
5	Shaft	Stainless steel X 12 CrNiS 1809 (AISI 416)
6	Mechanical seal	Graphite
7	Counterface	Ceramic
8	Seal holder plate	Technopolymer (series 45-60-70) Stainless steel X5 CrNi 1810 (AISI 304) series 90
9	Gaskets	NBR 70 Shore

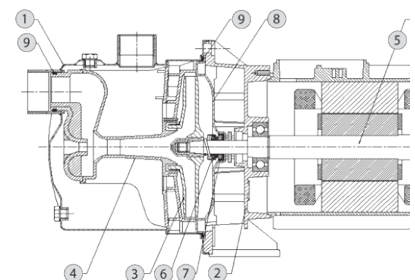

JETINOX

STAINLESS STEEL SELF-PRIMING PUMPS

HYDRAULIC PERFORMANCE

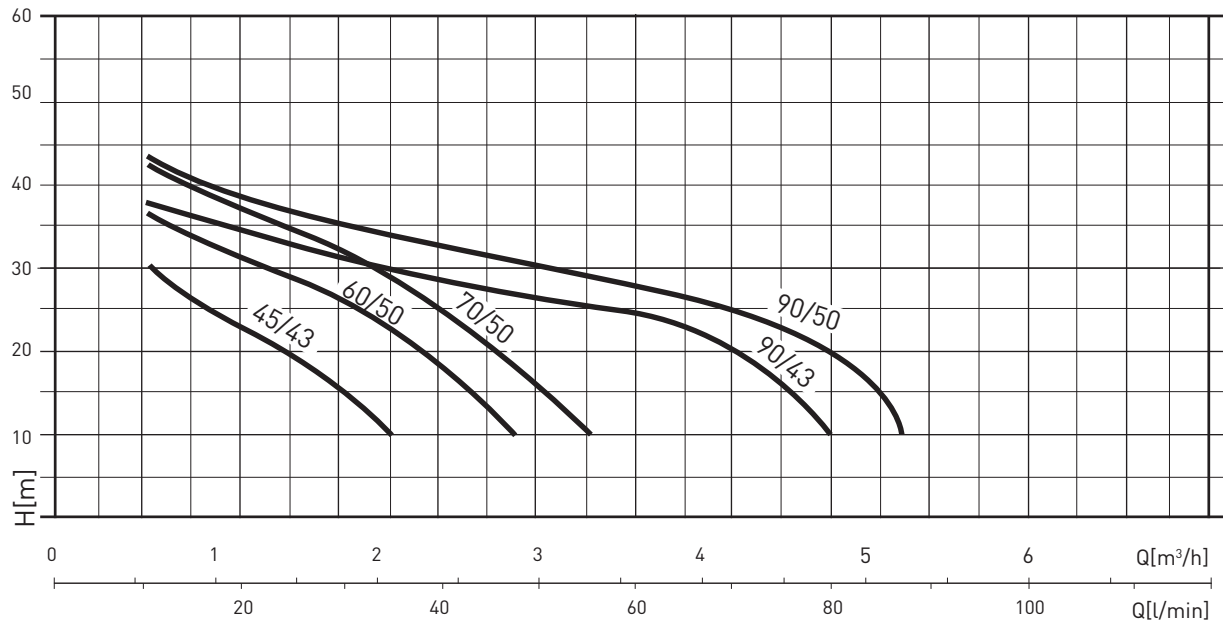

PERFORMANCE TABLE

MODEL	Motor power (P2)		Motor power (P1)		VOLT. (V)	I _n (A)	μF	Q	m.c.w.								
	HP	kW	HP	kW					l/min	0	10	20	30	40	50	60	70
									0	0,6	1,2	1,8	2,4	3	3,6	4,2	4,8
JETINOX 45/43 M	0,5	0,37	0,8	0,6	1~230	3	8		43	30	23	16	1				
JETINOX 60/50 M	0,75	0,55	1,1	0,8	1~230	4	12,5		46	36	31	26	18	6			
JETINOX 70/50 M	0,95	0,7	1,36	1,0	1~230	4,5	16		48	42,5	37,5	32	25	16,5	7		
JETINOX 90/43 M	1,0	0,75	1,8	1,3	1~230	6,5	20		43	38	34	32	29	27	25	21	10
JETINOX 90/50 M	1,2	0,9	2	1,5	1~230	7	25		50	42	39	37	33	30	27	25	20
JETINOX 60/50 C*	0,75	0,55	1,10	0,8	1~230	4	12,5		46	36	31	26	18	6			
JETINOX 70/50 C*	0,95	0,7	1,36	1,0	1~230	4,5	16		48	42,5	37,5	32	25	16,5	7		
JETINOX 90/43 C*	1,0	0,75	1,80	1,3	1~230	6,5	20		43	38	34	32	29	27	25	21	10
JETINOX 90/50 C*	1,2	0,9	2	1,5	1~230	7	25		50	42	39	37	33	30	27	25	20

JETINOX

STAINLESS STEEL SELF-PRIMING PUMPS

OVERALL DIMENSIONS AND WEIGHTS

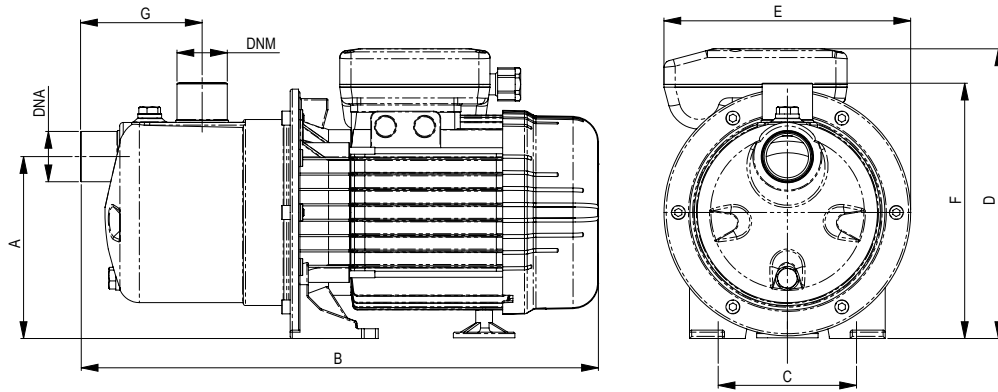

VERSION C

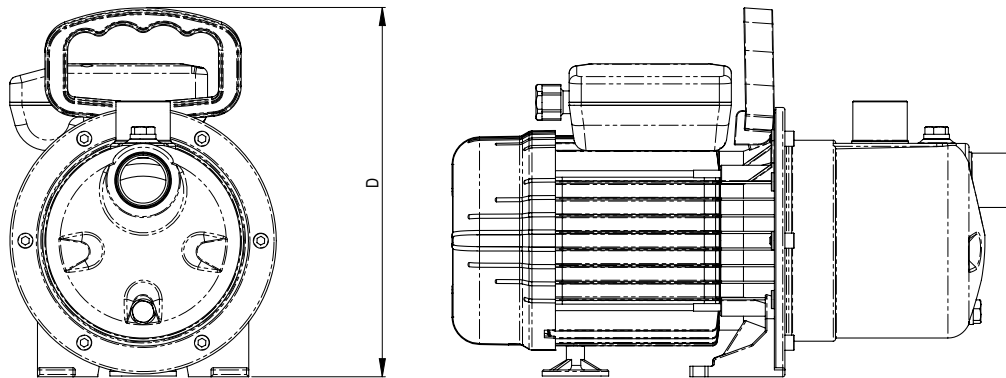

OVERALL DIMENSIONS AND WEIGHTS

MODEL	Dimensions mm.									WEIGHT (Kg)
	A	B	C	D	E	F	G	DNA	DNM	
JETINOX 45/43	130	352	100	199	177	185	87	1" F	1" F	4,7
JETINOX 60/50	130	370	100	207	177	185	87	1" F	1" F	8,2
JETINOX 60/50 C*	130	370	100	245	177	185	87	1" F	1" F	8,2
JETINOX 70/50	143	351	100	207	177	200	76	1" F	1" F	9,5
JETINOX 70/50 C*	143	351	100	245	177	200	76	1" F	1" F	9,5
JETINOX 90/43	158	395	141	207	205	214	98	1" 1/4 M	1" F	11
JETINOX 90/43 C*	158	395	141	275	205	214	98	1" 1/4 M	1" F	11
JETINOX 90/50	158	425	141	230	218	214	98	1" 1/4 M	1" F	13
JETINOX 90/50 C*	158	425	141	275	218	214	98	1" 1/4 M	1" F	13

MULTI EVO-A

SELF-PRIMING MULTISTAGE CENTRIFUGAL PUMPS

Multi EVO-A is a self-priming multi-stage centrifugal horizontal pump with an inlet with axial thread and an outlet with radial thread. The innovative, high efficiency hydraulic system is connected to a motor of the latest generation with a mechanical seal.

All models are certified for use with drinking water (ACS and DM174)

ADVANTAGES

The Multi EVO series pumps feature the following advantages:

- High reliability - thanks to the durable and innovative design
- Silent - more comfort for the user thanks to its silent operation
- Compact shape
- Many possible uses for the residential market
- Excellent priming ability

SPECIFICATIONS:

PUMP

- Hydraulic performance according to ISO 9906:2012 - Grade 3B
- Type of liquid: clean water without suspended solids or abrasive material
- Maximum temperature of the liquid 50°C
- Maximum operating pressure 8 bar

MOTOR

- Closed, air ventilated (TEFC)
- 2 poles, 50 Hz (n=2850 rpm)
- IE3 three-phase AC (P2 ≥ 0.75 kW)
- Protection level: IP55
- Insulation class: F
- Maximum ambient temperature 40°C
- Single-phase power supply with capacitor permanently on and thermal protection built into the motor casing.

APPLICATIONS

- Pressurising and supply
- Irrigation
- Use of rainwater
- Washing systems

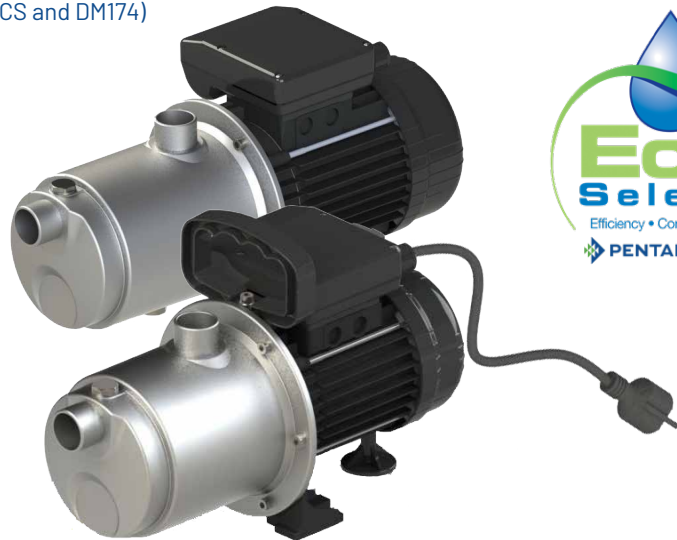

SELF-PRIMING CAPACITY

H20, T = 20°C,
Pa = 1000 hPa (mbar)
H3 = vertical section

H2 (m)	H3 (m) minimum							
	3-40	3-50	3-60	5-40	5-50	5-60	8-40	8-50
2	0.15	0.15	0.15	0.15	0.15	0.15	0.25	0.3
4	0.15	0.15	0.35	0.15	0.15	0.35	0.25	0.6
6	0.15	0.15	0.55	0.15	0.15	0.65	0.3	
8	0.55	0.35	0.55	0.45	0.55	0.65	0.65	

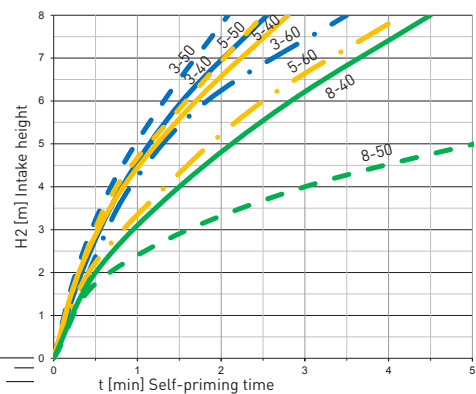
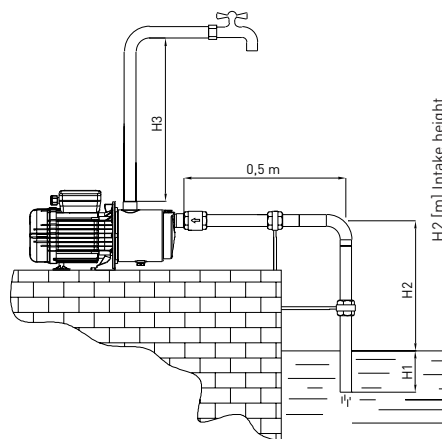

MULTI EVO-A

SELF-PRIMING MULTISTAGE CENTRIFUGAL PUMPS

CONSTRUCTION FEATURES

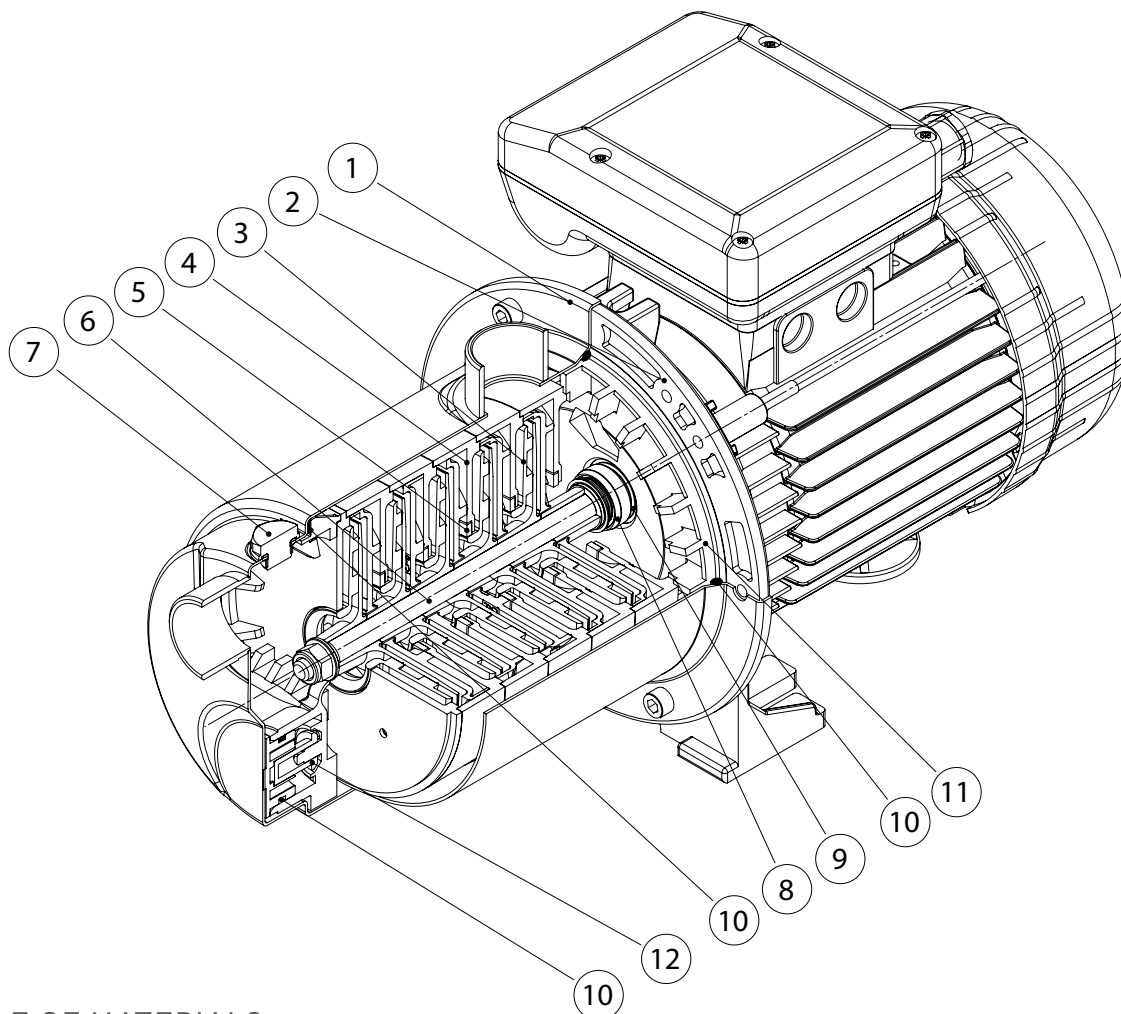

TABLE OF MATERIALS

Ref.	Component	Material
1	Pump body	Stainless steel Europe: EN10088-1 X5CrNi18-10 (1.4301) USA: AISI 304
2	Motor casing	Die-cast aluminium
3	Impeller	PPO reinforced with fibreglass
4	Diffuser	PPO reinforced with fibreglass
5	Wear ring	PTFE
6	Shaft (hydraulic part)	Stainless steel Europe: EN10088-1 X5CrNi18-10 (1.4301) USA: AISI 304
7	Inlet / outlet caps	Stainless steel Europe: EN10088-1 X8CrNiS18-9 (1.4305) USA: AISI 303
8	Mechanical seal	Carbon graphite / NBR / SS Europe: EN10088-1 X5CrNi18-10 (1.4301) USA: AISI 304
9	Counterface	Ceramic / NBR
10	Gaskets	NBR 70 Shore A
11	Seal holder plate	PPO reinforced with fibreglass
12	Priming valve	PPO reinforced with fibreglass

MULTI EVO-A 3

SELF-PRIMING MULTISTAGE CENTRIFUGAL PUMPS

HYDRAULIC PERFORMANCE

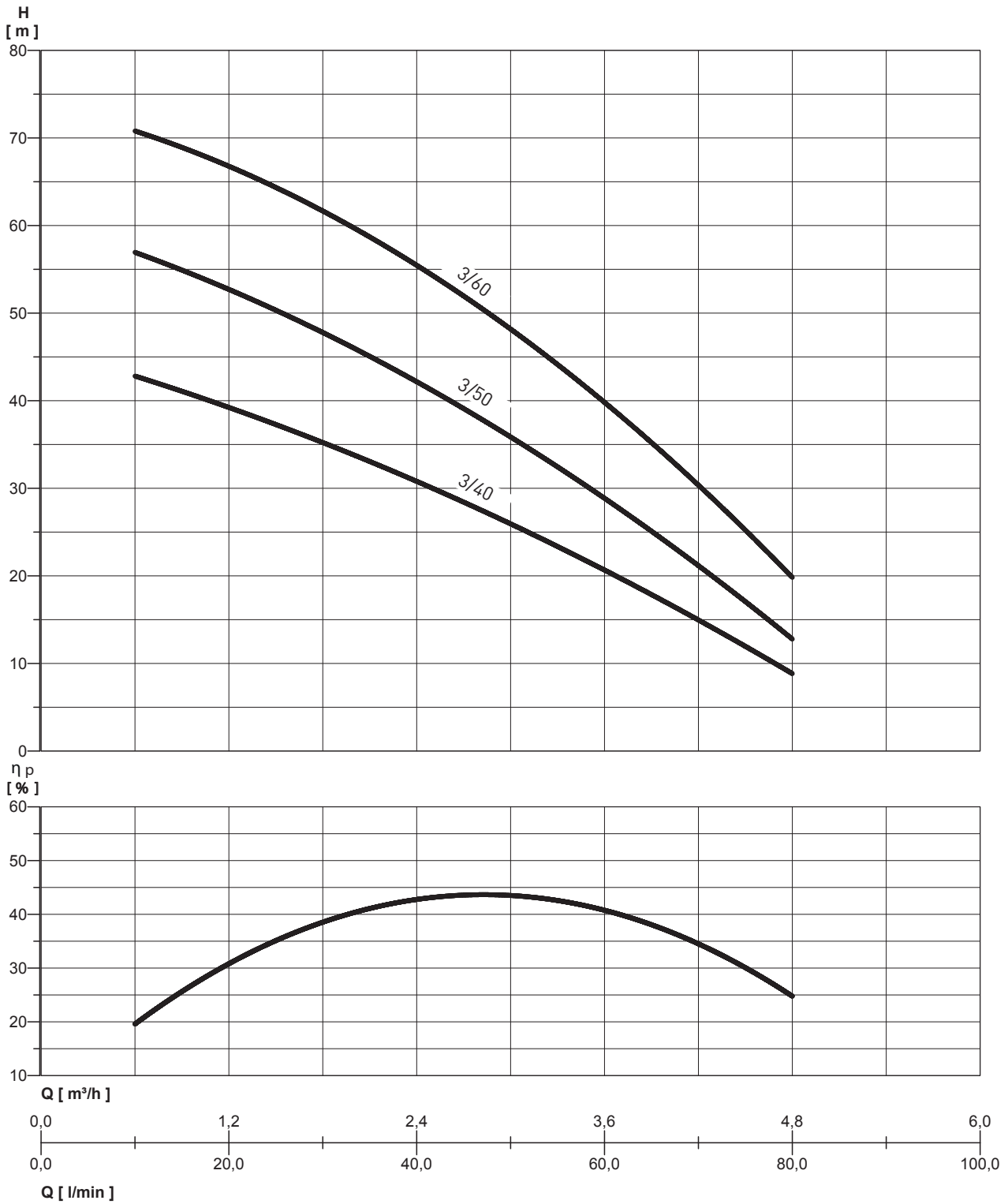

MULTI EVO-A 3

SELF-PRIMING MULTISTAGE CENTRIFUGAL PUMPS

PERFORMANCE TABLE

MODEL	Nominal power (P2)		Absorbed power (P1)		VOLT. (V)	In (A)	µF	0	total head in water column metres							
	HP	kW	HP	kW					l/min	10	20	30	40	50	60	80
									m ³ /h	0,6	1,2	1,8	2,4	3	3,6	4,8
MULTI EVO-A 3-40 M	0,68	0,51	1,1	0,8	1~230	3,7	12,5									
MULTI EVO-A 3-40 M-C*	0,68	0,51	1,1	0,8	1~230	3,7	12,5		42,5	39,5	35,5	31	25,5	20,5	9	
MULTI EVO-A 3-40 T	0,71	0,53	1,05	0,78	3~230/400	2,7 / 1,55	--									
MULTI EVO-A 3-50 M	0,94	0,7	1,34	1	1~230	4,4	16		56,5	53	48,5	42	35,5	28,6	13	
MULTI EVO-A 3-50 T	0,94	0,7	1,34	1	3~230/400	3,3 / 1,9	--									
MULTI EVO-A 3-60 M	1,2	0,9	1,68	1,25	1~230	5,7	20		70,5	67	62	55,5	48	39,5	20	
MULTI EVO-A 3-60 T	1,1	0,82	1,57	1,17	3~230/400	3,5 - 2	--									

* Version with cable, handle and schuko plug.

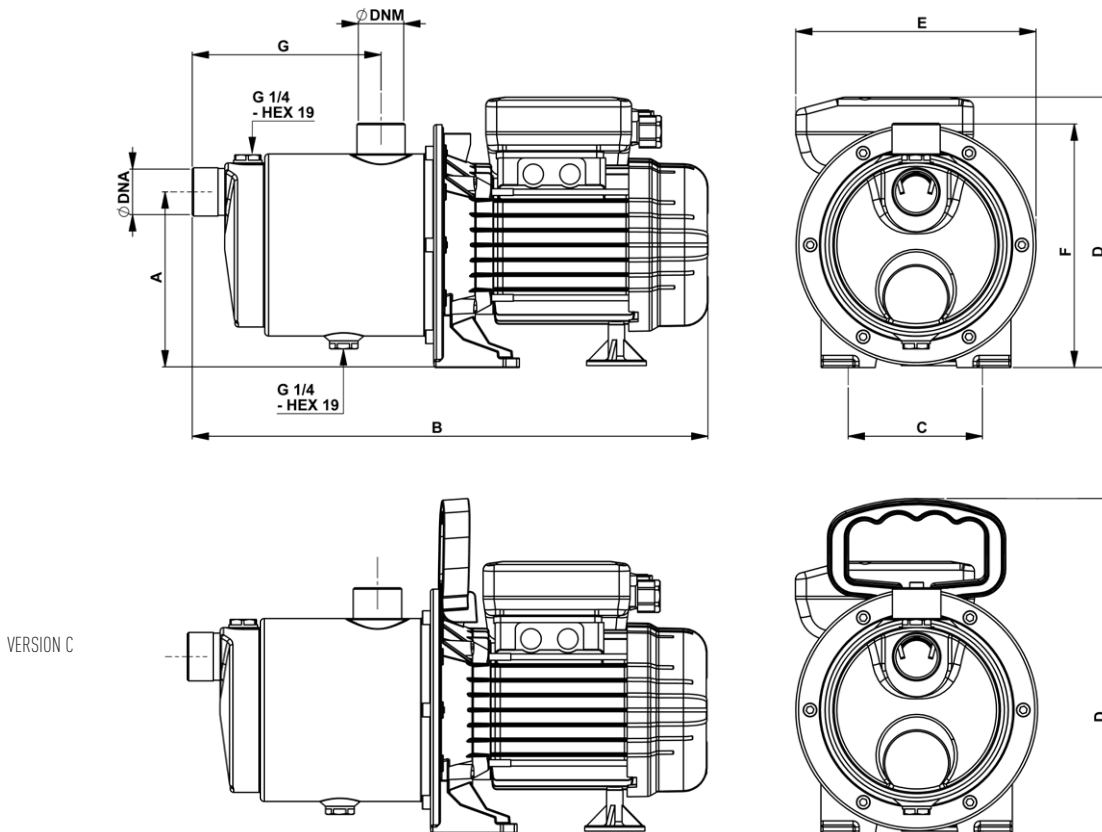

OVERALL DIMENSIONS AND WEIGHTS

MODEL	Dimensions mm.									WEIGHTS (Kg)
	A	B	C	D	E	F	G	DNA	DNM	
MULTI EVO-A 3-40 M	129	380	100	199	177	180	139	1"	1"	7,3
MULTI EVO-A 3-40 T	129	380	100	199	177	180	139	1"	1"	7,3
MULTI EVO-A 3-40 M-C*	129	380	100	245	177	180	139	1"	1"	7,6
MULTI EVO-A 3-50 M	129	422	100	207	177	180	162	1"	1"	9,3
MULTI EVO-A 3-50 T	129	422	100	207	177	180	162	1"	1"	9,3
MULTI EVO-A 3-60 M	129	422	100	207	177	180	162	1"	1"	10,8
MULTI EVO-A 3-60 T	129	422	100	207	177	180	162	1"	1"	10,8

MULTI EVO-A 5

SELF-PRIMING MULTISTAGE CENTRIFUGAL PUMPS

HYDRAULIC PERFORMANCE

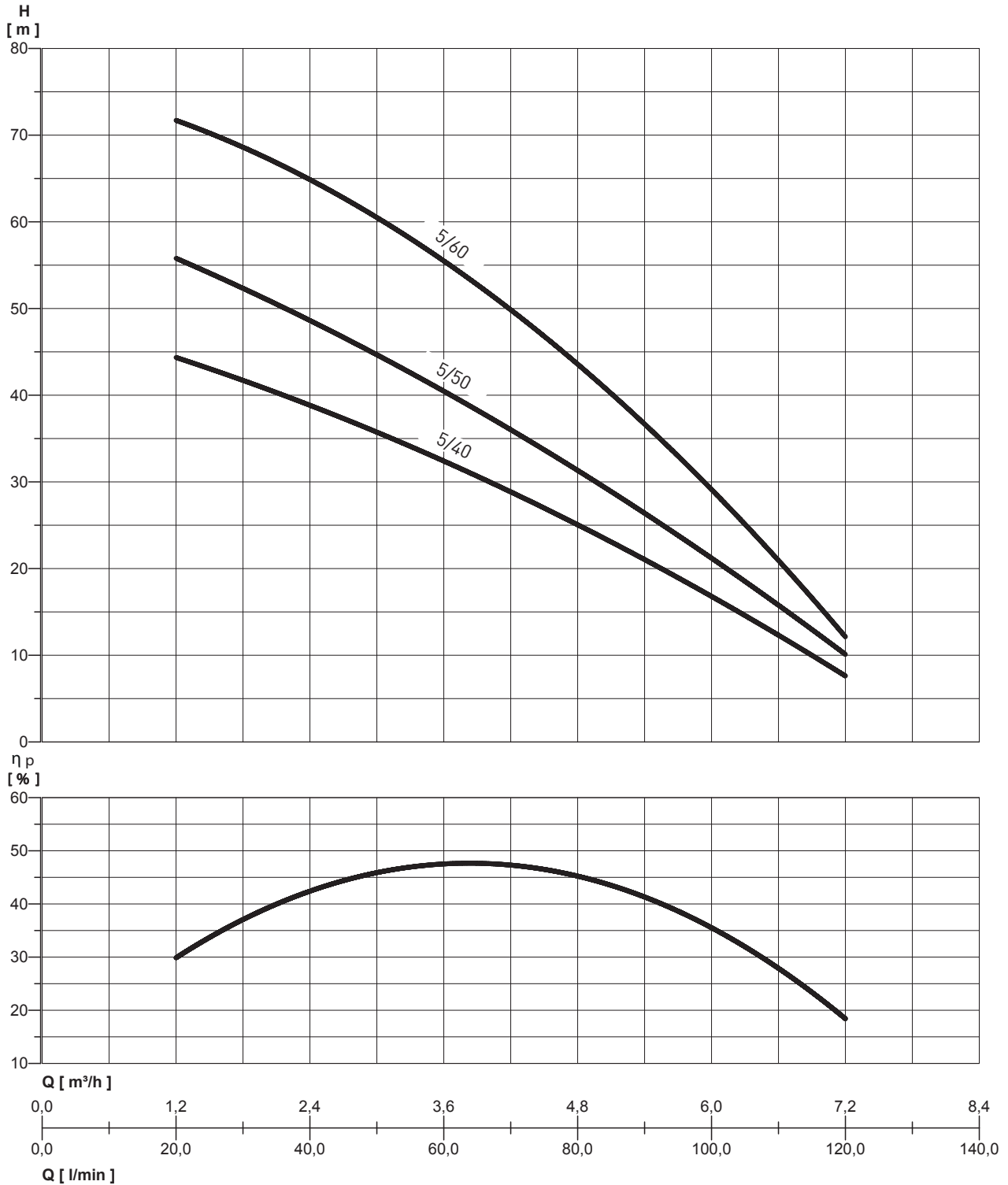

MULTI EVO-A 5

SELF-PRIMING MULTISTAGE CENTRIFUGAL PUMPS

PERFORMANCE TABLE

MODEL	Nominal power (P2)		Absorbed power (P1)		VOLT. (V)	In (A)	µF	Q	total head in water column metres								
	HP	kW	HP	kW					20	30	40	50	60	80	100	120	
									l/min	20	30	40	50	60	80	100	120
									m ³ /h	1,2	1,8	2,4	3	3,6	4,8	6	7,2
MULTI EVO-A 5-40 M	1	0,75	1,5	1,1	1~230	4,7	16			44,5	41,5	39	35,5	32,5	25	17	7,5
MULTI EVO-A 5-40 T	1	0,75	1,5	1,1	3~230/400	3,4 / 2	--										
MULTI EVO-A 5-50 M	1,27	0,95	1,8	1,35	1~230	6,2	20										
MULTI EVO-A 5-50 M-C*	1,27	0,95	1,8	1,35	1~230	6,2	20										
MULTI EVO-A 5-50 T	1,2	0,9	1,68	1,25	3~230/400	3,7 / 2,1	--										
MULTI EVO-A 5-60 M	1,6	1,2	2,2	1,65	1~230	7,5	31,5										
MULTI EVO-A 5-60 T	1,6	1,2	2,1	1,57	3~230/400	5,3 / 3,1	--										

* Version with cable, handle and schuko plug.

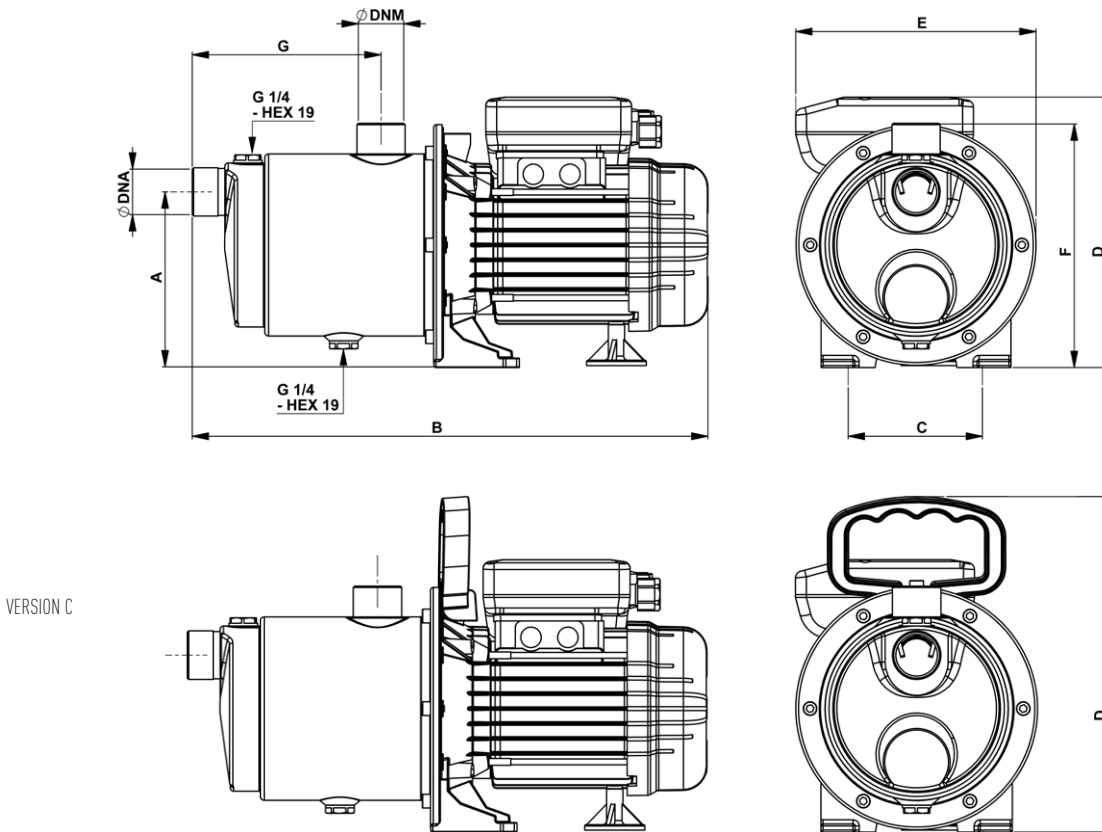

OVERALL DIMENSIONS AND WEIGHTS

MODEL	Dimensions mm.										WEIGHTS (Kg)
	A	B	C	D	E	F	G	DNA	DNM		
MULTI EVO-A 5-40 M	129	400	100	207	177	180	139	1"	1"	9	
MULTI EVO-A 5-40 T	129	400	100	207	177	180	139	1"	1"	9	
MULTI EVO-A 5-50 M	129	422	100	207	177	180	162	1"	1"	10,6	
MULTI EVO-A 5-50 T	129	422	100	207	177	180	162	1"	1"	10,6	
MULTI EVO-A 5-50 M-C*	129	422	100	245	177	180	162	1"	1"	11	
MULTI EVO-A 5-60 M	129	457	100	215	203	180	162	1"	1"	13,5	
MULTI EVO-A 5-60 T	129	457	100	215	177	180	162	1"	1"	13,5	

* Version with cable, handle and schuko plug.

MULTI EVO-A 8

SELF-PRIMING MULTISTAGE CENTRIFUGAL PUMPS

HYDRAULIC PERFORMANCE

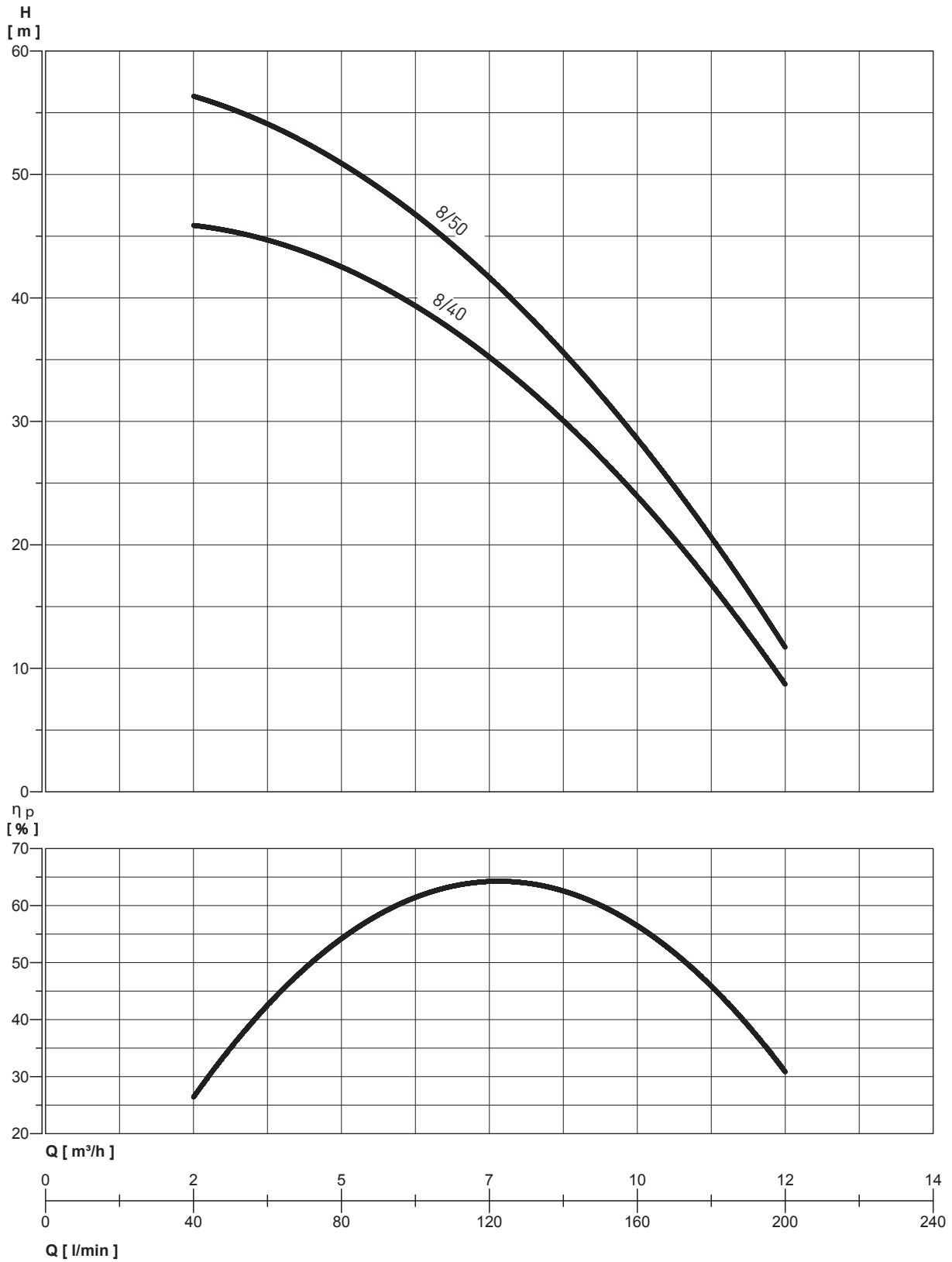

MULTI EVO-A 8

SELF-PRIMING MULTISTAGE CENTRIFUGAL PUMPS

PERFORMANCE TABLE

MODEL	Nominal power (P2)		Absorbed power (P1)		VOLT. (V)	In (A)	µF	Q	total head in water column metres											
	HP	kW	HP	kW					l/min	40	50	60	80	100	120	140	160	180	200	
									m ³ /h	2,4	3	3,6	4,8	6	7,2	8,4	9,6	10,8	12	
MULTI EVO-A 8-40 M	1,6	1,2	2,23	1,66	1~230	7,7	31,5													
MULTI EVO-A 8-40 T	1,6	1,18	2	1,5	3~230/400	5-2,95	--		46	46	45	42	40	36	30	24	17	9		
MULTI EVO-A 8-50 M	1,9	1,4	2,7	2	1~230	9	35													
MULTI EVO-A 8-50 T	1,9	1,4	2,6	1,95	3~230/400	6,7-4	--		56,5	55	54	51	47	42	36	28	21	12		

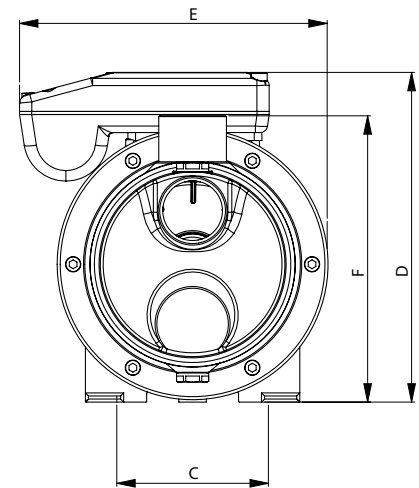
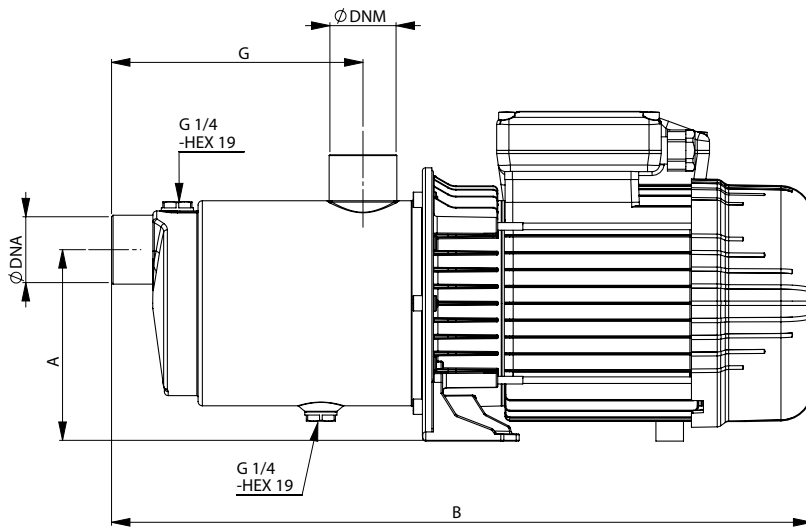

OVERALL DIMENSIONS AND WEIGHTS

MODEL	Dimensions mm.									WEIGHTS (Kg)
	A	B	C	D	E	F	G	DNA	DNM	
MULTI EVO-A 8-40 M	125	457	100	215	203	187	164	1" 1/4	1" 1/4	13,5
MULTI EVO-A 8-40 T	125	457	100	215	177	187	164	1" 1/4	1" 1/4	13,5
MULTI EVO-A 8-50 M	125	457	100	215	203	187	164	1" 1/4	1" 1/4	14,5
MULTI EVO-A 8-50 T	125	457	100	215	177	187	164	1" 1/4	1" 1/4	14,5